



Staveley Road, London, W4 3HU

£7,950 Per Calendar Month

WHITMAN & CO.

SALES · LETTINGS · COMMERCIAL

- Meticulously refurbished family home
- Great for transport links and amenities
- Formal drawing room and family room

- Lovely "Grove Park " Location
- Beautiful extended Kitchen/living/Dining room
- Master bedroom suite with large dressing room

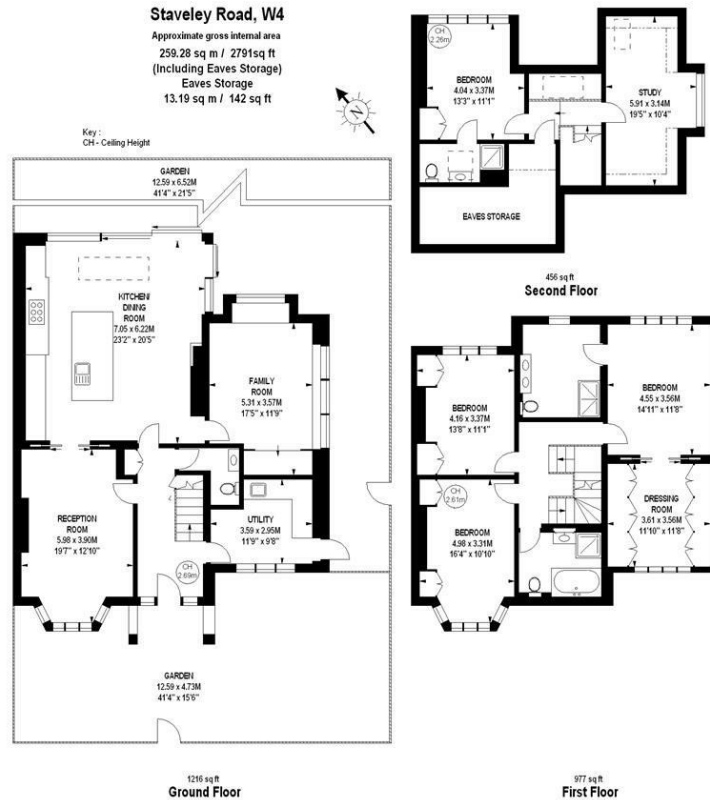

THE PROPERTY

A beautifully presented and meticulously refurbished family home situated within this extremely popular residential area in the heart of Chiswick's 'Grove Park', renowned for its open parks and riverside walks along the Thames towpath. Accommodation provides: spacious extended kitchen and dining area with bespoke kitchen island and fully integrated with an extensive range of high-quality appliances, full height sliding windows across the rear opening onto garden, skylight, tiled with underfloor heating, family room with fixed oversized window overlooking garden and recessed children's cubby area, drawing room, large utility room, cloakroom, master bedroom suite with his & hers dressing room and large shower room, three further bedrooms, family bathroom with shower, further en-suite shower room, study room, pleasant landscaped rear garden with large raised patio/dining area and front garden mainly paved with path. The property is available now and is offered with flexibility on the furnishing, subject to negotiation.

SITUATION

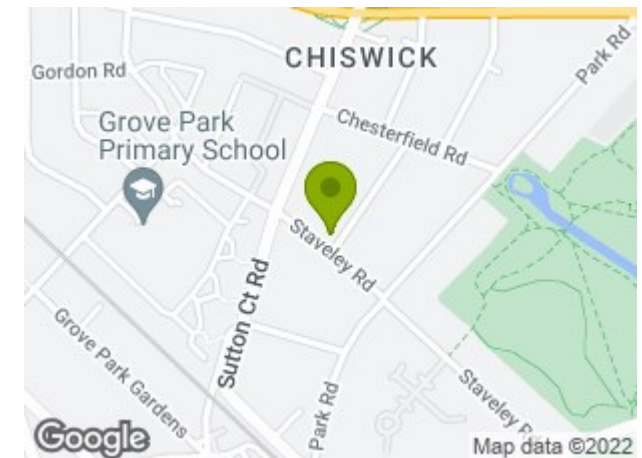

5-7 Turnham Green Terrace, Chiswick, London, W4 1RG

Tel 020 8747 8800

E-mail lettings@whitmanandco.com

Website www.whitmanandco.com